

Survey'd land

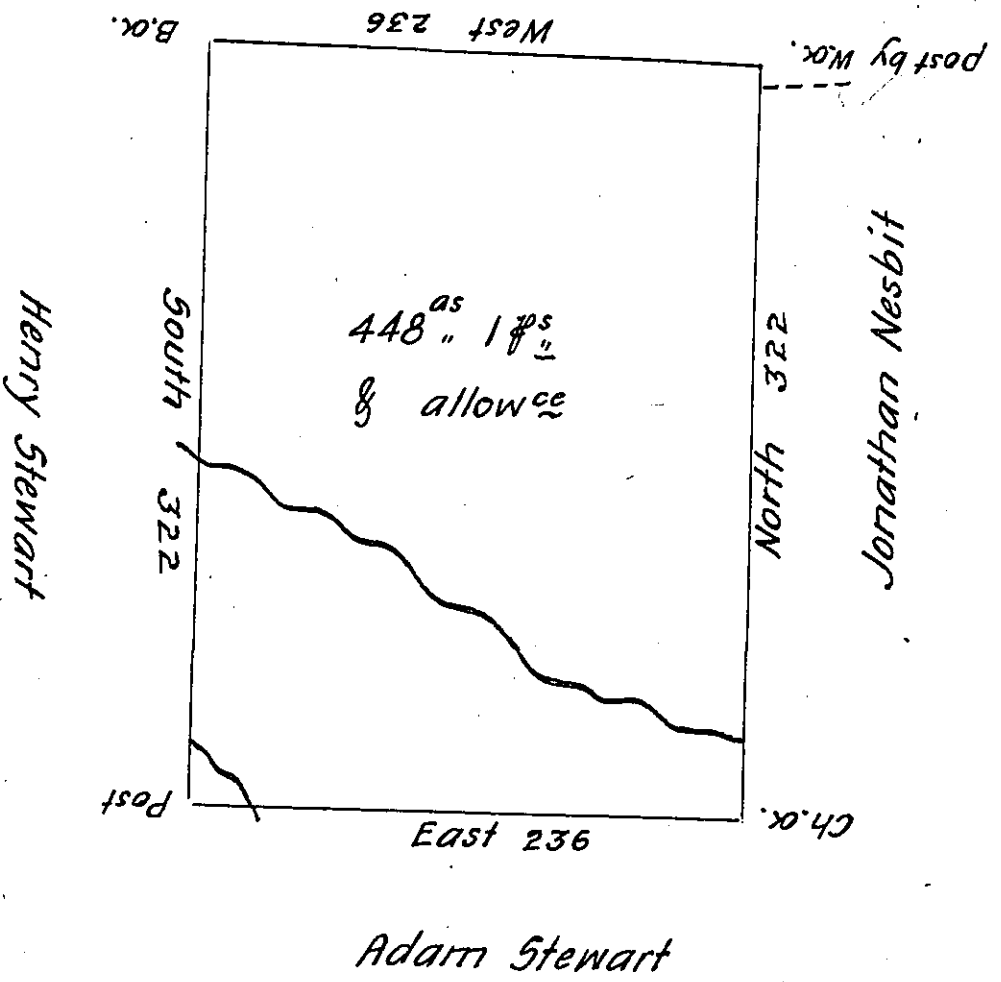

Situate on the waters of Spruce Run in Stewarts Valley Hunting-
don County Surveyed the 9th Day of October 1792 to Ann Stewart on her
Warrant dated the 27th Day of July 1792 Containing four hundred and forty
eight Acres one Perch and the allowance of Six $\frac{1}{2}$ Cent for Roads &c ~

Daniel Brodhead Esq. }
Surv^r: General. }

John Canan D.S.

IN TESTIMONY that the above is a copy of the original remaining on file in
the Department of Internal Affairs of Pennsylvania, made
conformably to an Act of Assembly approved the 16th day of
February, 1833, I have hereunto set my Hand and caused
the Seal of said Department to be affixed at Harrisburg,
this tenth day of December 1906

Isaac P. Simon
Secretary of Internal Affairs.